

# CITY OF NEW BRAUNFELS

## DEPARTMENT OF PUBLIC WORKS

### COMAL AVENUE

#### (E. SAN ANTONIO STREET TO E. GARDEN STREET)

#### MAINTENANCE PROJECT

**MAYOR**  
BARRON CASTEEL

**CITY COUNCIL**

- |                          |                |
|--------------------------|----------------|
| DISTRICT 1               | SHANE HINES    |
| DISTRICT 2               | JUSTIN MEADOWS |
| DISTRICT 3               | HARRY BOWERS   |
| DISTRICT 4               | MATHEW E. HOYT |
| DISTRICT 5/MAYOR PRO TEM | WAYNE PETERS   |
| DISTRICT 6               | LEAH A. GARCIA |



**SHEET INDEX**

SHT.	DESCRIPTION
C1	COVER SHEET
C2	GENERAL NOTES AND TYPICAL SECTION
C3	PROJECT LAYOUT AND EROSION CONTROL PLAN
C4	STRIPING PLAN
C5	STREET PLAN & PROFILE - COMAL AVENUE (STA. 1+00 TO STA. 5+25)
C6	STREET PLAN & PROFILE - COMAL AVENUE (STA. 5+25 TO STA. 9+25)
C7	STREET PLAN & PROFILE - COMAL AVENUE (STA. 9+25 TO STA. 13+25)
C8	STREET PLAN & PROFILE - COMAL AVENUE (STA. 13+25 TO STA. 17+31)
C9	INTERSECTION LAYOUTS
C10	DRIVEWAY PLANS
C11	DETAIL SHEET
C12	DETAIL SHEET
C13	DETAIL SHEET
C14	NBU NOTES AND DETAIL SHEET
C15	PAVEMENT CORE INFORMATION (BY RABA KISTNER CONSULTANTS)

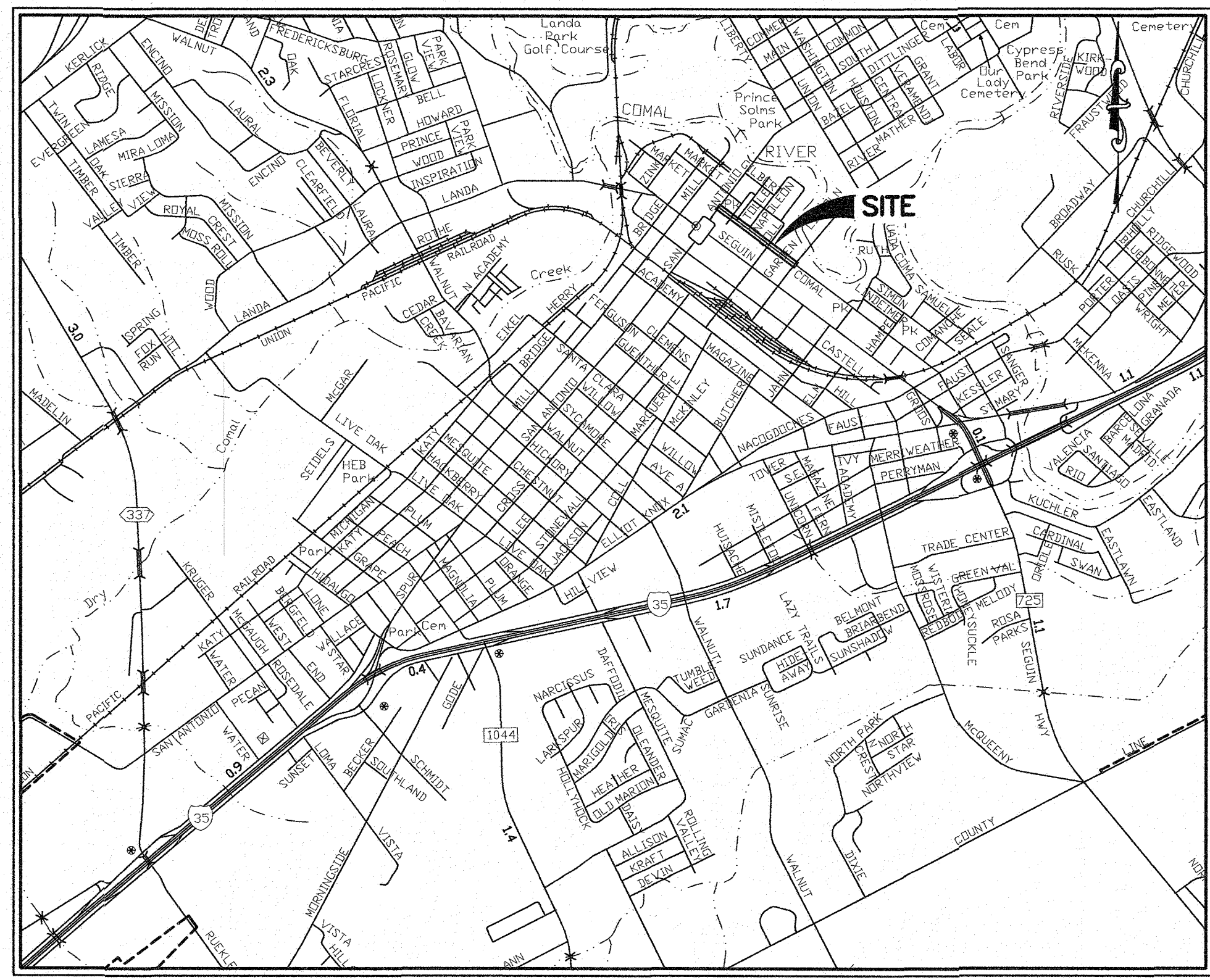

**LOCATION MAP**  
SCALE: 1" = 2000'

**TxDOT STANDARD DETAILS FOR COMAL AVENUE - MAINTENANCE PROJECT**

- T1 \* TCP (2-2)-12
- \* TCP (2-4)-12
- T2 \* PED-18 (SHEET 1 OF 4)
- \* PED-18 (SHEET 2 OF 4)
- \* PED-18 (SHEET 3 OF 4)
- \* PED-18 (SHEET 4 OF 4)
- T3 \* PM (1) - 12
- \* PM (2) - 12
- \* PM (3) - 12
- T4 \* EC(9)-16 (SHEET 1 OF 3)
- \* EC(9)-16 (SHEET 2 OF 3)
- \* EC(9)-16 (SHEET 3 OF 3)

THE STANDARD SHEETS SPECIFICALLY IDENTIFIED (\*) ABOVE HAVE BEEN SELECTED BY ME OR UNDER MY RESPONSIBLE SUPERVISION AS BEING APPLICABLE TO THIS PROJECT.

*John J. Moy, P.E.* 3/29/19  
JOHN J. MOY, P.E. DATE

SPECIFICATION ADOPTED BY THE TEXAS DEPARTMENT OF TRANSPORTATION, JUNE 1, 2014 AND SPECIFICATION ITEMS SHALL GOVERN ON THIS PROJECT.

**COVER SHEET FOR**  
COMAL AVENUE - MAINTENANCE PROJECT  
NEW BRAUNFELS, TEXAS

REVISIONS	DESCRIPTION

DRAWN BY:	D.G. III
CHECKED BY:	J.J.M.
DATE:	MARCH 2019
JOB NO.:	1809.01
<b>C1</b>	



























